

**FIRECHIEF®**  
making the world a safer place

# Kitchen STOVE GUARD

FSG I



**INSTALLATION  
& OPERATING  
INSTRUCTIONS**



**INTELLIGENT  
FIRE PREVENTION**



**LOW  
MAINTENANCE**



**AUTO POWER  
SHUT-OFF**



# THANK YOU FOR CHOSING THE FIRECHIEF KITCHEN STOVE GUARD

Firechief Stove Guard is a safety product for domestic kitchens. The Stove Guard consists of a state-of-the-art Heat Sensor that monitors the cooker from above, and a Control Unit that cuts the power to the cooker if a dangerous situation occurs. The Control Unit is installed behind the cooker or inside a kitchen cabinet close to the cooker. Be sure to read this manual prior to commencing installation.

## PACKAGE CONTENTS:

- Heat Sensor SGS1010
- Battery (CR2032)
- IR lens extension
- Control Unit SGC510-2
- Junction Box SGI510-2JF
- Main manual
- Cupboard sticker
- Screws



## SAFETY RULES

**Firechief Stove Guard does not prevent all potentially dangerous situations, but it makes the use of the cooker significantly safer. Never leave the cooker unattended. Always check compliance with local regulations.**

- For indoor use only.
- Do not use in a professional kitchen.
- Do not hold the Heat Sensor close to the ear. It can cause hearing damage when in alarm or test mode.
- Do not leave children alone with the product or any of its parts or packaging. There is a risk of choking.
- Do not disassemble the product.
- Do not immerse the Heat Sensor in water.
- The Stove Guard will not emit an alarm if the temperature of the cooker is too low to identify a dangerous situation, or if the cooker has an automatic limitation of temperature increase.
- The Stove Guard will not completely isolate the cooker. It must never be used to turn off the cooker's power supply for service/repair.
- Do not short-circuit, charge, open or heat the batteries. There is a risk of explosion.

**The operating instructions, accessories and stickers must accompany the product. Follow the safety guidance for safe use of Stove Guard. If you have questions about the product, ask a specialist or refer to [Firechiefglobal.com](http://Firechiefglobal.com)**

# CONTENTS

<b>1</b>	<b>INSTALLATION</b>	<b>4–12</b>
	Installation of the Heat Sensor	5
	<b>RECOMMENDED</b>	
	<b>1a</b> Installation under cooker hood	
	 P.5-6	
	<b>OPTIONAL</b>	
	<b>1b</b> Wall mounting	
	 P.7-8	
	<b>1c</b> Ceiling mounting	
	 P.9-10	
	Installation of the Control Unit	11
	Function test	12
<b>2</b>	<b>USER GUIDE</b>	<b>13–20</b>
	Getting started with Firechief Stove Guard	13
	Read before using Firechief Stove Guard	14–15
	Avoiding false alarms	14
	After alarm: Cookers with mechanical controls	14
	After alarm: Cookers with touch controls	14
	Dislocation alarm	14
	Action in the event of an alarm	15
	Other settings	16–17
	Changing the sensitivity level	16
	Checking the sensitivity level	17
	Resetting the Heat Sensor to factory settings	17
	Pairing devices	17
	Frequently asked questions	18–19
<b>3</b>	<b>TECHNICAL SPECIFICATIONS</b>	<b>20</b>
	The Stove Guard	20
	Cooker connection	21
	Warranty	22
	Disposal	22
	EU Declaration of Conformity	22

# INSTALLATION

1

## INSTALLING THE STOVE GUARD

Follow these instructions for correct installation.



**STEP 1:**  
Installation of  
the Heat Sensor  
p. 4-10

**STEP 2:**  
Installation of  
the Control Unit  
p. 11

**STEP 3:**  
Function test  
p. 12

## INSTALLATION OF THE HEAT SENSOR

The recommended place to install the Heat Sensor is directly above the centre of the cooker, under the cooker hood. The Heat Sensor can also be mounted on a wall with a mounting bracket or on the ceiling. Follow these instructions for correct installation.

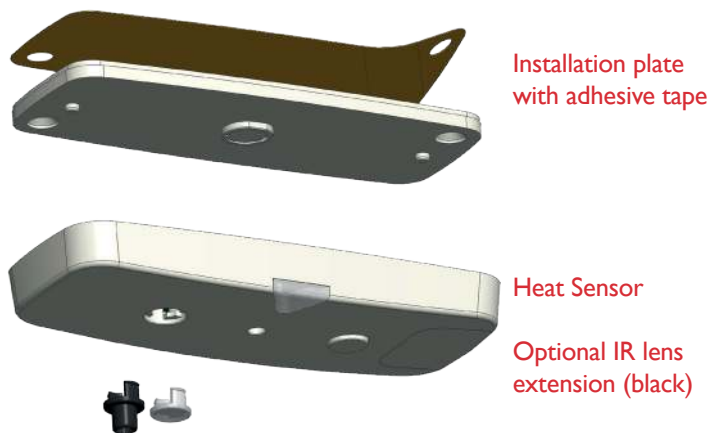

Installation plate  
with adhesive tape

Heat Sensor

Optional IR lens  
extension (black)

## INSTALLATION LOCATIONS

### RECOMMENDED

Ia Installation under cooker hood



### OPTIONAL

Ib Wall mounting



Mounting bracket SAI 1000-FBx  
required for wall installations -  
available separately.

Ic Ceiling mounting



For ceiling installations, the  
supplied IR lens extension  
must also be fitted. See page 9.

# COOKER HOOD

Allow the Heat Sensor to reach room temperature before use.  
 The power to the cooker must be switched off (at the consumer unit).  
 See table on page 6 for the mounting location and follow instructions 1–4.

## SELECTING THE MOUNTING LOCATION

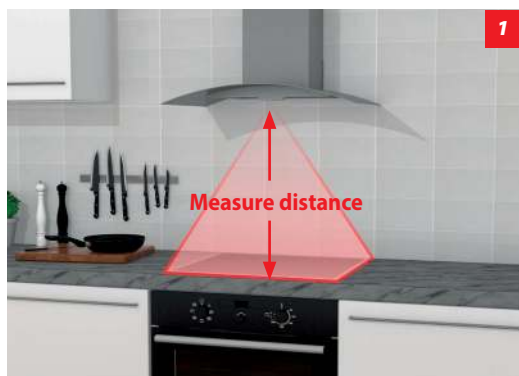

Measure the installation height. The Heat Sensor should be centred above the cooker, preferably within Zone 1 (see diagram at bottom of the page). It can be attached to the grease filter. It is also important to ensure the minimum distance from any lights underneath the hood is 10 cm (5 cm is enough for LED lamp).

Please note: Zone 1 is recommended for best performance.

## MOUNTING THE INSTALLATION PLATE



If there is a metal mesh grease filter on the cooker hood, make sure it is free of grease and dry.

Carefully remove the protective film from the installation plate. Press for at least a minute while attaching installation plate to allow adhesive to work.

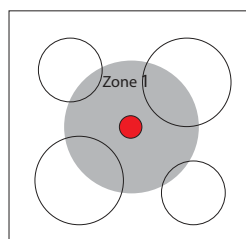
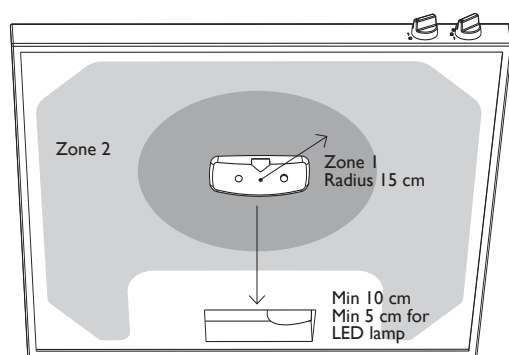

Zone 1 is immediately above the middle of the cooker plates. Max 15 cm from the centre.

# INSTALLATION UNDER COOKER HOOD



3



4

## STARTING THE HEAT SENSOR

Insert the battery and check step 4 before placing the Heat Sensor on the installation plate.

Briefly press the button. The LED should flash green.



Watch the film:  
<https://youtu.be/SAeFdB3nP3s>  
Installation

SCAN ME

## CHECK INSTALLATION HEIGHT

If the distance from cooker to Heat Sensor is more than 60 cm, the Heat Sensor's sensitivity level must be adjusted manually.

Please refer to the table below together with the information on page 16. Also watch the video on sensitivity configuration below.



Watch the film:  
<https://youtu.be/oy-hrT7nTQM>  
Setting the sensitivity level

SCAN ME

DISTANCE FROM COOKER TO HEAT SENSOR	MOUNTING LOCATION		SENSITIVITY LEVEL CONFIGURATION	
	0-60 cm wide cooker	61-90 cm wide cooker	Sensitivity	Acknowledgement "beep(s)"
81-100 cm	Zone 1 & Zone 2	Zone 1	3 presses	•••
76-80 cm	Zone 1 Zone 2*	Zone 1*	4 presses	••••
71-75 cm			5 presses	•••••
65-70 cm			6 presses	••••••
61-64 cm			7 presses	•••••••
45-60 cm Factory setting			8 presses	••••••••

\* The installation may not in all cases meet all EN standard requirements. See FAQ, page 18, point 4

Please note: the sensitivity level of the Heat Sensor is confirmed by the appropriate sound pattern sequence only (not LED flashes).

## WALL

Allow the Heat Sensor to reach room temperature before use.  
The power to the cooker must be switched off (at the consumer unit).  
See table on page 8 for the mounting location and follow instructions 1–5.

### SELECT THE REQUIRED LOCATION AND MOUNT THE BRACKET

Wall mounting requires a bracket (SAI1000-FBx), sold separately. The bracket can be fastened to the wall using adhesive tape or screws.

See the detailed mounting instructions in the bracket package. Make sure that the bracket is positioned correctly so that the Heat Sensor faces towards the centre of the cooker.

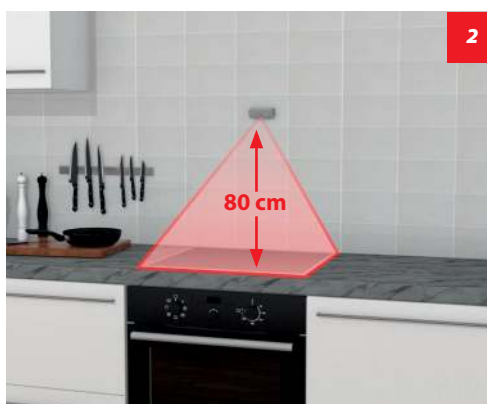

### MOUNTING THE INSTALLATION PLATE

Carefully remove the protective film from the installation plate. Press for at least a minute while attaching installation plate to allow adhesive to work.

**Mounting height on the wall above the cooker**  
Max 90 cm wide cooker.

Recommended: 80 cm  
Alternatively: 65–79 cm\*

See mounting instructions provided separately with the bracket.

\* For wall mounting with a distance less than 80 cm between the Heat Sensor and the cooker, the installation will not in all cases meet all EN standard requirements.

# WALL MOUNTING WITH BRACKET

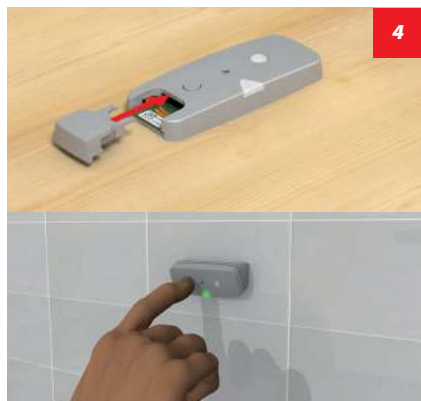

## STARTING THE HEAT SENSOR

Insert the battery and check step 5 before placing the Heat Sensor on the installation plate.

Briefly press the button. The LED should flash green.



Watch the film:  
<https://youtu.be/SAeFdB3nP3s>  
 Installation



Watch the film:  
<https://youtu.be/oy-hrT7nTQM>  
 Setting the sensitivity level

## SET THE SENSITIVITY LEVEL

Set the Heat Sensor's sensitivity level according to the mounting height (as described in the table below) by evenly pressing the Sensor's button. The factory setting for the sensitivity level is 45–60 cm above the cooker. Please refer to the table below together with the information on page 16. Also watch the video on sensitivity configuration below.

DISTANCE FROM COOKER TO HEAT SENSOR	SENSITIVITY LEVEL CONFIGURATION	
	Sensitivity	Acknowledgement "beep(s)"
70–80 cm *	3 presses	•••
65–69 cm *	4 presses	••••

\* 80cm recommended. For wall mounting with a distance less than 80cm between the Heat Sensor and the cooker, the installation may not in all cases meet all EN standard requirements.

Please note: the sensitivity level of the Sensor is confirmed by the appropriate sound pattern sequence only (not LED flashes).



# CEILING

Allow the Heat Sensor to reach room temperature before use.  
 The power to the cooker must be switched off (at the consumer unit).  
 See table on page 10 for the mounting location and follow instructions 1–5.



## REPLACE LENS

Carefully lift the lens with a screwdriver. Insert the IR lens extension (included) as shown in the picture. The extension should point directly upwards at an angle of 90°. If the extension moves around, check that it has been inserted the right way round.

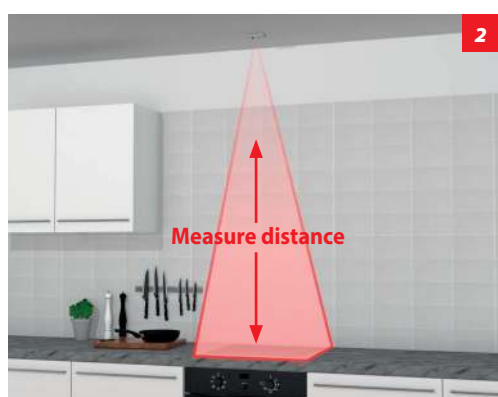

## FINDING THE MOUNTING POSITION

Measure the distance between the cooker and ceiling. Place the Heat Sensor directly above the center point of the cooker. Make sure that the surface is clean and dry.

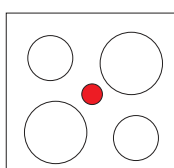

## MOUNTING THE INSTALLATION PLATE

Make sure that the ceiling is free of grease and dry.

Carefully remove the protective film from the installation plate. Press for at least a minute while attaching installation plate to allow adhesive to work.

# CEILING MOUNTING WITH IR LENS EXTENSION



## STARTING THE HEAT SENSOR

Insert the battery and check step 5 before placing the Heat Sensor on the installation plate.

Briefly press the button. The LED should flash green.



Watch the film:  
<https://youtu.be/SAeFdB3nP3s>  
 Installation



## SET SENSITIVITY LEVEL

Set the sensitivity level according to the mounting height (as described in the table below) by evenly pressing the Sensor's button. The Heat Sensor's sensitivity level must always be adjusted when installing it on the ceiling. Please refer to the table below together with the information on page 16. Also watch the video on sensitivity configuration below.



Watch the film:  
<https://youtu.be/oy-hrT7nTQM>  
 Setting the sensitivity level

DISTANCE FROM COOKER TO HEAT SENSOR		SENSITIVITY LEVEL CONFIGURATION	
Mounting height above the cooker	0-90 cm wide cooker	Sensitivity	Number of "beep(s)"
160-200 cm	Recommended: Immediately above the middle of the cooker. Alternatively: Farther out into the room with bracket. See the bracket package for mounting instructions.	1 press	•
Mounting height above the cooker	0-90 cm wide cooker		
140-159 cm	Recommended: Immediately above the middle of the cooker. Alternatively: Farther out into the room with bracket. See the bracket package for mounting instructions.	2 presses	••

Please note: the sensitivity level of the Sensor is confirmed by the appropriate sound pattern sequence only (not LED flashes).

# CONTROL UNIT

It is a statutory requirement that the Junction Box is installed by an authorized electrician. The power to the cooker must be disconnected throughout the entire installation.

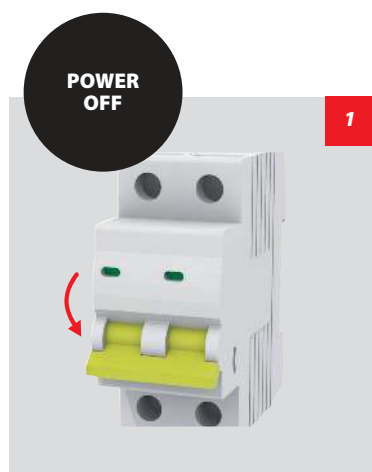

## Disconnect the power

Switch off the power at the consumer unit.

**Note!** Do **not** turn on the Consumer unit before the Heat Sensor is set up and ready for a function test.



## Connecting the Junction Box

For correct installation of the Junction Box, ensure to refer to the wiring diagram on page 21. The Control Unit will then plug & play into the Junction Box



Watch the film:  
<https://youtu.be/s7ato2xYQUY>  
 Test alarm

# FUNCTION TEST

The installation is completed when the function test has been passed. The Heat Sensor will then give an alarm in a dangerous situation. The user manual, accessories and stickers should be stored close to the Stove Guard for future reference.

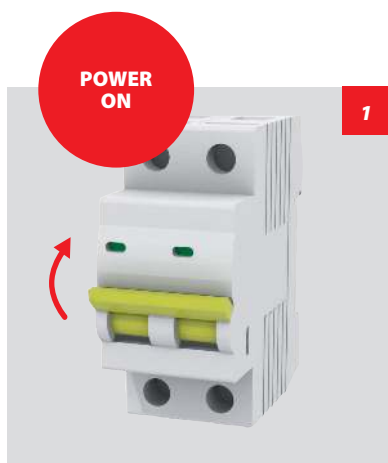

## Return the power

Switch on the power at the consumer unit.

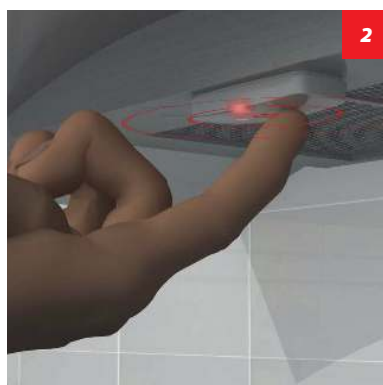

## Perform function test

Wait 30 seconds after switching on the power. Press and hold the button until the Heat Sensor emits a “beep” (●) and the red LED flashes. Release the button.

The Control Unit will switch off the cooker and give an alarm signal every 5 seconds. The Heat Sensor will also emit a test alarm after a few seconds.

**Note!** Ensure that there is no power going to any of the cooking plates.



## Reset the alarm

It is important to reset the alarm after a function test to return power to the cooker. Reset the test alarm by pressing the button once.

Check that the cooker can be turned on (or that there is voltage in the Control Unit).

If the Heat Sensor does not respond or if the test alarm cannot be reset, see page 18, points 5 and 6.

## Installation is now ready.

When connecting the Stove Guard for the first time it is recommended to wait 15 minutes before normal cooker use to allow the Stove Guard to perform final system checks.

# USER GUIDE

## GETTING STARTED

The installation is completed when the function test has been passed.

The Heat Sensor will then give an alarm in a dangerous situation. The user manual, accessories and stickers should be stored close to the Stove Guard for future reference.



After installation, the Heat Sensor may start making short “beeps” every five seconds while the stove is being used (“pre-alarm”).



If there is not a dangerous situation, press the button to indicate that the situation is safe.



The Heat Sensor has then learned more about your cooking habits and you can continue cooking.

### Please note:

When installing the Heat Sensor on the ceiling, the learning function will not be operational. The Heat Sensor will automatically sound and switch the cooker off in the event of an increased heat condition.

The Heat Sensor learns and adjusts, when the user resets the pre-alarm. See FAQ page 19, point 14.

In order to reset the system, turn all controls off. The Stove Guard will automatically reset itself after the heat condition has cleared and the cooker has cooled down.

## AVOIDING FALSE ALARMS

Be sure to use a pan that covers the entire hotplate to prevent false alarms. Also, using a lid is recommended. Always use the cooker hood to extract fumes if you have one.

If you have a freestanding cooker or an oven under the hob, the oven controls will also be turned off once the power supply to the cooker or hob has been switched off by the alarm.

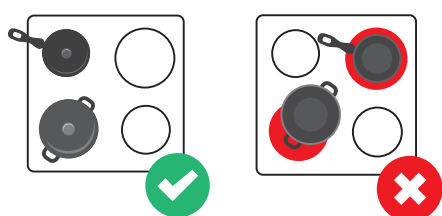

## AFTER ALARM

### Mechanical controls

If the Stove Guard has turned the cooker off, first turn all cooker controls to '0', then press the Heat Sensor button once. After this, the cooker can be used normally. With ceiling installation, the reset button needs to be pressed to return the power.

### Touch controls

If the Stove Guard has turned the cooker off, press the Heat Sensor button once. After this, the cooker can be used normally.

In some cases you must wait until the cooker has cooled down to continue to use.







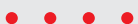

## DISLOCATION ALARM

Removing the Heat Sensor from the installation plate cuts off the power to the cooker. Returning the Sensor back to the installation plate returns the power to the cooker. Press the Heat Sensor button once.

## ACTION IN THE EVENT OF AN ALARM

The cooker will automatically be ready for use after the Stove Guard has detected that the hazardous situation is over, and all the controls are set to “0”.

See the alarm overview below for actions.

SOUND	MEANING	MEASURES
<b>Heat Sensor</b> 4 “beeps” with a 1-second interval. 	<b>Dislocation Alarm</b> The Heat Sensor is removed from the installation plate.	Return the Heat Sensor to the installation plate with the LED facing the user.
<b>Heat Sensor</b> Short “beeps” with 5-second intervals. 	<b>Pre-Alarm</b> The Heat Sensor sounds an alert to warn user of danger before disconnecting the cooker.	If the pre-alarm is triggered during normal cooking; press the Heat Sensor button once while the pre-alarm sounds. The alarm will be turned off and the sensitivity adjusts slightly, to suit your cooking style.
<b>Heat Sensor</b> Many quick “beeps” followed by a long, very loud sound. 	<b>Switch-off Alarm</b> The cooker is switched off.	Make sure that the controls are set to “0”. Press the Heat Sensor button once to return the power to the cooker.
<b>Control Unit</b> Short “ring” with 5-second intervals. 	<b>No power</b> The power to the cooker has been cut off.	Make sure that the controls are set to “0”. Wait until the cooker has cooled down after it has been disconnected then press the Heat Sensor button once to return the power. If the cooker cannot be switched back on, see FAQ, question 9, page 19.
<b>Control Unit</b> Continuous “rings”. 	<b>No power</b> The cooker is too hot for the power to be turned back on.	Make sure that the controls are set to “0”. Wait until the cooker has cooled down and the Control Unit starts emitting a short “ring” with 5-second intervals as described in the section above, or press the Heat Sensor button once to reconnect the cooker. If the alarm does not stop, follow the instructions on page 19, FAQ question 9, and press again.
<b>Control Unit</b> Short and long “ring” with 10-second intervals. 	<b>No power due to Auto-diagnostics Alarm</b> The cooker has been disconnected due to a temporary fault (automatic error diagnosis).	Make sure that the controls are set to “0”. Wait until the cooker has cooled down after it has been disconnected then press the Heat Sensor button once to return the power. If the cooker cannot be switched back on, see FAQ, question 3, page 18.
<b>Heat Sensor</b> One “beep” per minute.  Or <b>Control Unit</b> One “ring” per minute. 	<b>Battery Alarm</b> The Heat Sensor has a low battery.	The Heat Sensor battery is low and needs to be replaced. Pressing the button once at this time delays the alarm for at least 12 hours.

# OTHER SETTINGS

## CHANGE THE SENSITIVITY LEVEL

Due to differences in kitchen environments, the sensitivity level of the Heat Sensor may have to be adjusted manually.

### 1. Remove the Sensor from the installation plate

The Heat Sensor emits 4 “beeps” ( ●●●● ). The cooker is turned off.

### 2. Adjust the sensitivity level

See pages 6-10 for sensitivity levels to be applied.

Place the Heat Sensor on the table (as shown in the picture). Press and hold in the button until 2 “beeps” ( ●● ) are heard. Release the button. The correct sensitivity can now be input.



**Note!** When selecting the correct sensitivity level it is important the process is not rushed. Ensure the sensor button is pressed down firmly each time, holding for 1 second before releasing.

Be sure to pause for 1 second between each press.

### 3. Confirmation of setting

After 5-15 seconds, the Heat Sensor will confirm the sensitivity setting with the same number of “beeps”.

In case of error, start from step 2 again. Please note that the sensitivity level is confirmed by the appropriate number of “beeps” only and not LED flashes.

### 4. Activate the Sensor

Return the Heat Sensor correctly onto the installation plate. Press the button once.



Watch the film:  
<https://youtu.be/oy-hrT7nTQM>  
Setting the sensitivity level



## CHECKING THE SENSITIVITY LEVEL

1. Remove the Sensor from the installation plate. (The Sensor gives 4 “beeps” ( ●●●● ) and the cooker is switched off.)

2. Press and hold the button (approx. 10 sec.) until 2 “beeps” ( ●● ) are heard.

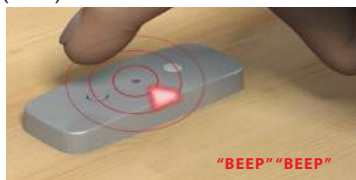

3. An unadjusted Sensor’s sensitivity setting is level 8, and when checking the level, the Sensor gives a set of “beeps” as follows: 8 - 8 - 5 - 8. If the sensitivity was adjusted to level 4, the sensor would give “beeps”: 4 - 4 - 5 - 4.

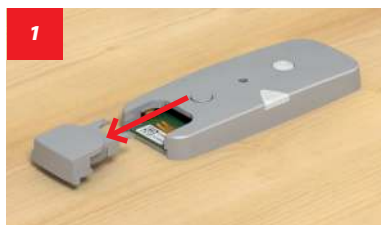

**Watch the film:**  
<https://youtu.be/aV6Cl7x9mJY>  
 Checking sensitivity level

## RESET THE HEAT SENSOR TO FACTORY SETTINGS

Remove the Sensor from the installation plate. (The Sensor gives 4 “beeps” ( ●●●● ) power is cut off to the cooker).

1. Remove the battery lid.

2. Press the button once.

3. Return the battery lid. The Heat Sensor shall make a “beep”.

4. Press and hold the button until the three “beeps” are heard. Release.

If three “beeps” cannot be heard, something went wrong. Repeat from Step 1. Return the Heat Sensor to its installation plate and press the button once.

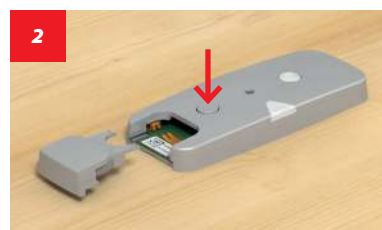

**Watch the film:**  
[https://youtu.be/uJ4T\\_gMJAQ](https://youtu.be/uJ4T_gMJAQ)  
 Reset to factory settings

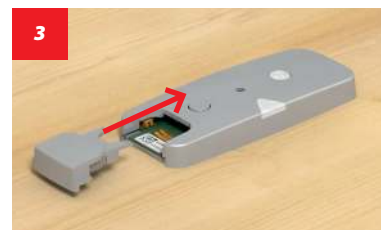

## PAIRING DEVICES

The units are already paired at the factory. When replacing the Heat Sensor or the Control Unit, the devices must be paired again.

**Note!** The Heat Sensor must be placed on the installation plate during pairing.

1. Check that the cooker is connected to the power supply.
2. Press and hold the reset button firmly for 20 seconds. The Control Unit will emit two sets of clicks and buzzes (approximately after 5 and 20

seconds). Release the reset button after the second set of clicks and buzzes. The Control Unit is now ready to be paired.

3. Press and hold the NEW Heat Sensor button until it emits a “beep” ( ● ) and a red LED flashes. The Control Unit makes a buzzing sound and the Heat Sensor emits a “beep” ( ● ).
4. After 5 seconds, the Heat Sensor gives an alarm (first



one “beep” and after a while continuous beeping). The Control Unit and the Heat Sensor are now successfully paired.

5. Reset the test alarm by pressing shortly the Heat Sensor button. Check that the cooker can be turned on. If the Heat Sensor does not respond or if the test alarm cannot be reset, see FAQ, page 18, points 5 and 6.

# FREQUENTLY ASKED QUESTIONS

## 1. I cannot turn on the cooker, and there is no signal from the Control Unit

**ANSWER 1:** The Heat Sensor has been removed or placed incorrectly on the installation plate. The Heat Sensor should be positioned parallel to the installation plate and it is recommended to have the LED facing the user.

**ANSWER 2:** If the Heat Sensor is correctly positioned on the installation plate, the Control Unit's overheating protection has switched the cooker's power off. The cooker can be switched on again by turning off the power supply for a few seconds using the cooker's fuse (in the consumer unit). If the overheating protection fails again, move the Control Unit to a cooler or better-ventilated place.

## 2. The Stove Guard emits alarms during normal cooking

**ANSWER 1:** If the Heat Sensor is positioned lower than 90 cm above the cooker, it has a learning function (see page 13). Pressing the Heat Sensor button during the pre-alarm lowers the sensitivity slightly.

Other causes of alarms during normal cooking:

- A pot is removed from a hot hotplate
- A kettle/pot does not cover the hotplate
- Cooking without a lid
- A hot frying pan placed on the hotplate

**ANSWER 2:** If measures to prevent unnecessary alarms have been performed a few times and the Heat Sensor still emits alarms in the same situation, the sensitivity should be adjusted less sensitive manually, for example from level 4 to level 5. See page 16.

## 3. The Auto-diagnostics alarm was not reset by pressing the Heat Sensor button once

**ANSWER 1:** The Auto-diagnostics alarm (Control Unit emits one short and one long "ring" every ten seconds) may be triggered if the Heat Sensor is not on the installation plate, if it is positioned incorrectly, or if it is covered by dirt or grease. It can also be triggered by a problem with the radio connection or malfunction of the Control Unit.

**ANSWER 2:** Make sure that the Heat Sensor is firmly attached to the installation plate and that it is positioned correctly. The LED should be facing the user (see page 5). Clean the Heat Sensor with a lint-free cloth moistened with soapy water. Press the Heat Sensor button once.

**ANSWER 3:** Turn off the cooker's power from the consumer unit for 15 seconds.

**ANSWER 4:** If the fault diagnosis switches off the cooker again, contact the retailer. If the cooker is still turned off due to the fault diagnosis, it can only be used for 5 minutes at a time by turning the power off for 15 seconds as described in answer 2 above (EN requirements).

## 4. Placing of the Heat Sensor in zones that do not necessarily match all EN standard requirements

**ANSWER:** According to the EN standard, the Heat Sensor should "see" the base of the pot in order to measure the temperature. In these zones (see the tables on pages 5, 7 and 9), the Heat Sensor cannot see the bottom of pots with high edges and may identify a hazardous situation somewhat more slowly, but is still safe to use.

## 5. During the function test, the Heat Sensor does not emit a sound when the button is pressed

**ANSWER:** Make sure that the battery has power and is inserted properly, "plus-side" up.

## 6. The test alarm cannot be reset

**ANSWER:** First try the function test, see page 12. If this does not fix the problem, turn off the cooker's power at the consumer unit for 15 seconds and repeat the function test. Wait for 5 seconds before resetting the alarm.

## 7. The Stove Guard did not give an alarm in a dangerous situation

**ANSWER:** It is possible that the temperature was not high enough to be identified as a dangerous situation. The Heat Sensor takes different cooking situations into account, including high-temperature cooking, and should not give an alarm too easily. Therefore, the Stove Guard only emits an alarm when a certain temperature (or rate of temperature rise) is detected, but still long before a real risk situation. However, it is important to check the Stove Guard's function (see the next sections).

- Make sure that the Heat Sensor is correctly installed. See page 5 and after.
- If the Heat Sensor is properly installed, turn on a hotplate and perform a function test, see page 12. Make sure the Control Unit turns off the cooker. If the function test fails, contact the retailer.
- When mounting lower than 90 cm above the cooker, it is possible to change the sensitivity of the Heat Sensor, so it reacts earlier. Increase the sensitivity by one or two steps. See page 14.

**8. I cancelled the pre-alarm by mistake, even though the alarm was triggered by a dangerous situation. Has the Heat Sensor become too insensitive now?**

**ANSWER:** Deactivating the pre-alarm changes the sensitivity, but only to a small extent. This can therefore be carried out a few times without the alarm becoming insensitive.

**9. I cannot turn on the cooker and the Control Unit emits a ring tone almost continuously**

**ANSWER:** The cooker is locked due to several repeated alarms for the maximum temperature. Unlock by turning off the cooker's power at the consumer unit for 15 seconds.

**10. How do you test Stove Guard with an induction cooker?**

**ANSWER:** You need an adapter plate that allows the use of all cookware on an induction cooker (available from many retailers) or an induction suitable cooking vessel. Place the adapter plate on a cooker and perform a heat test by turning on the plate. This test is not absolutely necessary, as potential problems are eventually solved by the Auto-diagnostics.

**Note!** The test is recommended when retrofitting the cooker and ceiling-mounted Heat Sensor.

**11. The Heat Sensor gives an alarm when I make coffee with an espresso pot**

Espresso pots are often much smaller than the hotplate, and the heat from the plate makes the Stove Guard think there is a dangerous situation. Use suitable sized cooking vessels.

**ANSWER:** Deactivate the alarm by pressing the Heat Sensor button. The sensitivity level of the Heat Sensor will not adapt automatically, as the espresso maker triggered an alarm for maximum temperature and therefore self-learning will not take place.

**12. What do I do if the Heat Sensor or the Control Unit must be replaced with a new one?**

**ANSWER:** Contact the retailer for a new part. When replacing, pair the devices. See page 15.

**13. Where can I find the Heat Sensor model number?**

**ANSWER:** On the underside of the Heat Sensor there is a sticker with the model number.

**14. Why does the learning sensitivity function not work when I install the Heat Sensor on the ceiling?**

**ANSWER:** The Heat Sensor "learns" based on the frequency of manually reset pre-alarms.

The Heat Sensor's ability to automatically return the power to the cooker after an event enables the user to not have to reset the alarm manually (by using an additional reset button or reaching to the ceiling to press the button of the Heat Sensor). The Heat Sensor will not learn and adjust its sensitivity level because there are no manual reset requirements for pre-alarms when on the ceiling.

# TECHNICAL SPECIFICATIONS

# 3

- Alarm signal 80 dB(A) @ 1 m • RF 433 MHz • Patented EP1861839, EP2902710
- Fulfils EN 50615:2015 Standard for stove guards (Eurofins Expert Services Oy)

## THE HEAT SENSOR

Signal LED  
should face towards user

IR lens  
(Lens extension for  
high installations)

Button

Battery lid  
(Battery 1 x CR2032)

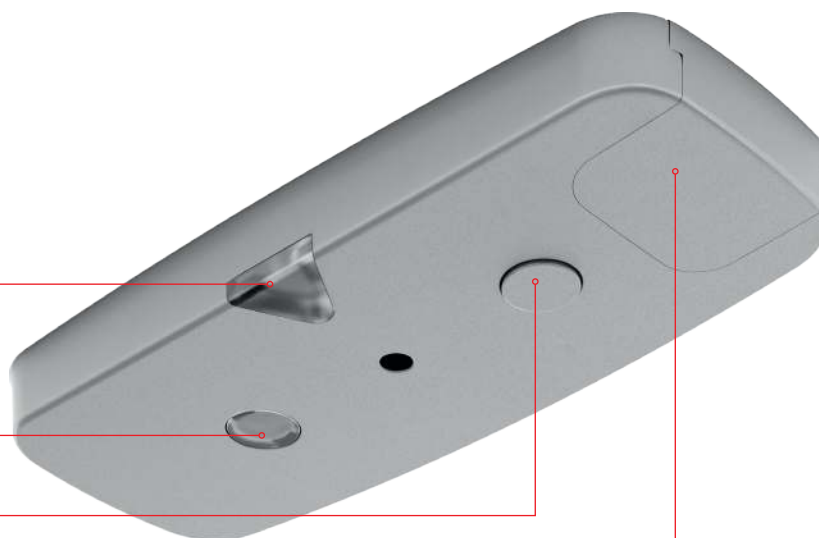

## THE CONTROL UNIT

- Voltage 230–400 VAC
- Extremely low energy use (approx. 1 W)
- Automatic electrical switch



## THE JUNCTION BOX

- For safe connections  
up to 10 mm<sup>2</sup>  
wires



# COOKER CONNECTION

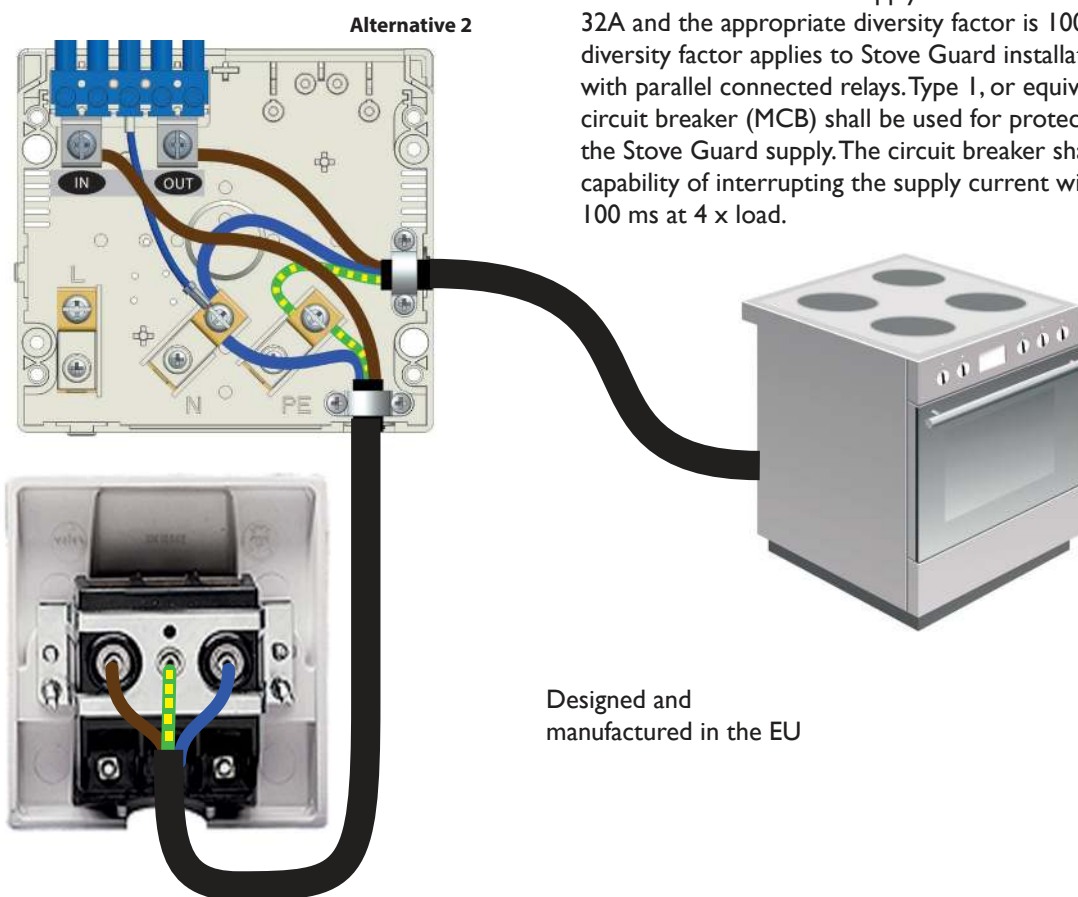
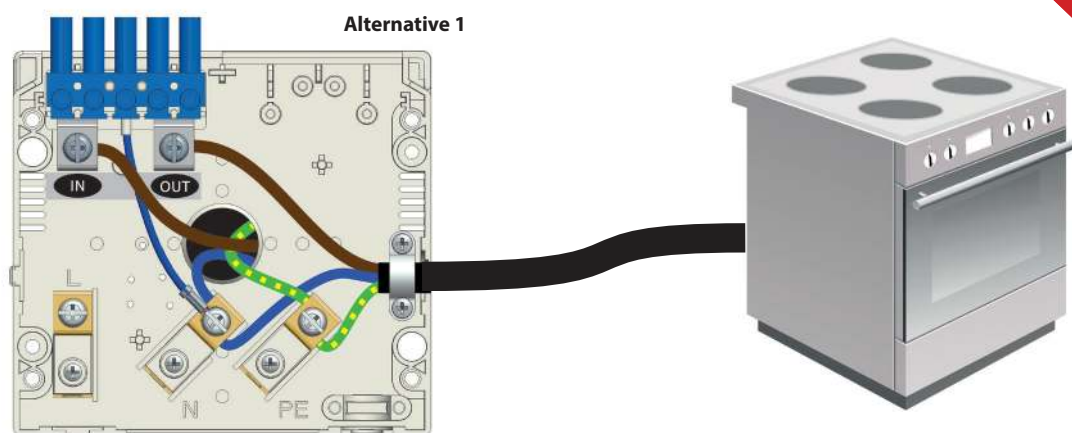

Stove Guard's maximum supply current allowed is 32A and the appropriate diversity factor is 100%. The diversity factor applies to Stove Guard installations with parallel connected relays. Type 1, or equivalent circuit breaker (MCB) shall be used for protecting the Stove Guard supply. The circuit breaker shall have capability of interrupting the supply current within 100 ms at 4 x load.

Designed and manufactured in the EU



For indoor use only.  
Do not use in a professional kitchen.  
The Control Unit must be installed by an authorised electrician.

# WARRANTY

The warranty applies from the date of purchase. This warranty does not affect your legal rights. The warranty covers the use of the product under normal circumstances in private households and housing associations.

The warranty is limited to replacement of defective components.

The warranty applies only when the product is used according to the instructions. It does not cover damage caused by misuse, improper handling, use of force, batteries, dust, dirt, water or other environmental factors.

If you have a warranty claim, contact your retailer for instructions. We only accept authorized returns with a complete description of the defect. After the warranty period, you will be charged for repairs and it may not always be possible to have the product repaired.

Warranty claims do not extend the original warranty period, and the warranty on spare parts expires at the same time as the product warranty. Unless otherwise provided by law, the manufacturer shall not be liable for additional claims, including for personal or material damage arising from the use of the product or its deficient function or malfunctioning.

## DISPOSAL

Information about disposal of electrical and electronic waste (private households). EU Directive 2012/19/EC on recycling of waste electrical and electronic equipment (WEEE)

This symbol on the Stove Guard and associated documents means that this product should not be disposed of with normal household waste. For proper handling and recycling, this product must be delivered to a separate collection point where it will be accepted free of charge. The product can be returned to your local retailer when purchasing a corresponding new product.

Proper disposal of this product helps to save valuable resources and prevent potentially harmful effects on human health and on the environment, which may otherwise occur in the event of improper handling of waste.



## EU Declaration of Conformity

We declare that this product corresponds to:

- Radio Equipment Directive (RED) 2014/53/EU
- The Low Voltage Directive 2014/35/EU
- The RoHS Directive on the Use of Hazardous Substances 2011/65/EU

... and the following harmonized standards and technical data are used:

- Fire prevention devices for hobs EN 50615:2015 (Cat. B)\*
- EN 60730-1:2011 (Control Unit); Clause H.27 (Sensor)
- Device Requirements EN 60335-2-31:2014, Clause 30
- EN 60670-1:2005+A1:2013, EN 60670-22:2006
- Electromagnetic Compatibility and Radio Spectrum Matters (ERM) EN 300 220-1 V3.1.1, EN 300 220-2 V3.1.1
- Electromagnetic Compatibility (EMC) EN 301 489-1 V2.1.1 and EN 301 489-3 V2.1.1
- RoHS EN 50581:2012

\* EN 50615: 2015 European standard for stove guards, approved 05.01.2015, available 06.03.2015. The full title of the standard: Household and similar electrical appliances. Safety. Particular requirements for devices for fire prevention and suppression for electric hobs (cooktops). Tested by an independent, accredited testing laboratory (Eurofins Expert Services Finland).

The Control Unit is independently tested and categorised as Category 2 Receiver. Reference: ETSI EN 300 200-2 V3.1.1 Short Range Devices (SRD) operating in the frequency range 25 MHz to 1 000 MHz; Part 2: Harmonised Standard covering the essential requirements of article 3.2 of Directive 2014/53/EU for non-specific radio equipment. Subclause 4.4.2 Blocking.

# NOTES



T: 0330 999 0019

E: [sales@firechiefglobal.com](mailto:sales@firechiefglobal.com)

[www.firechiefglobal.com](http://www.firechiefglobal.com)

